

LED



IP65

-40°C

+50°C



Application

- Ideal to be used in the oilfield, chemical industry, steel industry, power, port, Petroleum etc.
- Harsh environment, moist area.
- Gas explosive environment: Group IIA; IIB.
- Zone 1, Zone2; Zone 21, Zone 22.
- Temperature class: T1 to T6.

Characteristics of performance

- Light Source: American CREE LED, save almost 90% on energy than the incandescent lamp and 60% on energy over the energy saving lamp.
- Long Service Life: with the average service life as long as 100,000 hours, maintenance free.
- Multi-voltage: 90 to 264VAC or 18 to 55VDC
- Feature: LED anti-dazzle lens, making the light more gentle, glare free. It will not cause weariness to the operators' eyes.
- The housing is made of aluminium alloy. With the surface electrostatic spraying treatment, it is anti corrosion.
- Multi-mounting options: Ceiling mounted, wall mounted etc.
- The PC transparency has a high light transmittance, perfect impact resistance, designed to withstand the harsh industrial applications.

Main specification

Input Voltage	90-264VAC (18-43VAC / 18-55VDC optional)
Output Voltage	14VDC
Frequency	50Hz / 60Hz
Ingress Protection	IP65
Anti Corrosion Grade	WF2
Insulation Grade	I
Space Height Ratio	1.2
Leading-in cable diameter	φ 6mm - φ 8mm
Dimension	φ 147x140mm
Net Weight	1.3Kg

Ordering reference

Ordering Reference	Light Source	Rated wattage (W)	Light output (lm)	Equivalent to
				Compact fluorescent lamp
BC9200A	LED	4.3W	1,144	28W
BC9200B	LED	2.3W	572	18W

Light distribution curve

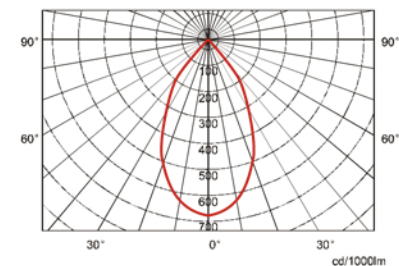

Drawing of dimension (Dimensions in mm)

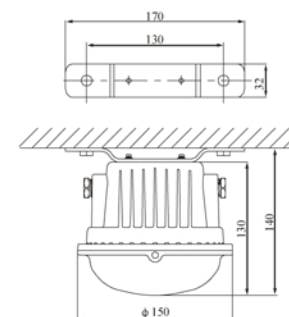

Ex Code: Ex de II C T6
Standard: GB3836.1, GB3836.3
IEC60079-7:2007,MOD

